

# RD2 Architecture & Interior Design

# RD2

D E S I G N

✉ [rd2@rd2design.com](mailto:rd2@rd2design.com)

🌐 <https://rd2design.com>

📞 +971 52 2218100

📞 +971 4 5544102

A wondrous place where  
the horizon meets the sea.

*A wind, ever soulful  
and divine.*

A place where inspiration is complete.

*all brought to life*

at RD2 architecture & interior design.

Imagine a canvas, a blank expanse that you can fill with your dreams, your hopes and everything you have to offer. It's a space that can be your sanctuary, a place where you can relax and escape the everyday stress of life.

Creating a dwelling that is both personal and inviting is no easy task, but with the **right architecture & design**, it is possible. To choose colors that speak to your deepest whims, shapes, and angles that feed the wonder that lives in your head. Nothing typical, yet everything innovative and inspiring.

RD2 Architecture and Interior Design is here to help you realize your dreams with the wealth of experience and knowledge. Passion is the vehicle used to create unique commercial sites and residencies that **reflect personality & a sense of style**.

### *Where Innovation Meets Future*

There is a love for art resting deep inside all of us. Imagination is hard-wired into our character and detail. Human beings thrive on the moments that allow for clarity and self-expression. **Cultivating a place that feels comfortable, inviting, & inspiring is the purest reflection of individuality.**

That's why RD2 Architecture and Interior Design believes in creating spaces that are both personal and beautiful. Each project is carefully designed to reflect the client's **personal style and needs**.

## **Sustainable & Eco-Friendly Designs**

### **Sustainable And Eco-Friendly Designs**

RD2 invests in sustainable and eco-friendly designs. Every project is carefully executed to make sure that it meets high-quality standards for sustainability.

### **Value Engineering**

This initiative takes times to carefully evaluate each project to make sure that it meets high standards for quality and efficiency. Adding value to a vision is crucial to creativity.

### **Quality Control**

RD2 believes in making art that flows against the current, breaks the mold of the expected. Individuality is meant to be positive, constructive, and rewarding.

### **Cost Control**

Every project is created with a regard for intricate design while remaining sensitive to budgeting needs.



# Our Services

This creative initiative values the art of meeting every expectation and desire.  
The precedent is met in a multitude of services:

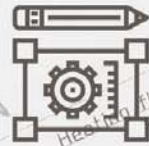

Turn key Concept  
Design & Fit Out



Space  
Planning



3D  
Visualization



Lighting  
Design



Interior Designing  
and Styling



Online Shop for  
Art and Sculpture



Project  
Management

## Our Core Values

### Our Philosophy

Our company thrives on the ability to stand out against the crowd. A place where beauty can thrive. Each design is meant to touch the heart; to speak to the soul in a way that encourages growth and sustainability.

RD2 implements these values into every project. The goal is to create a lasting and positive experience for everyone that encounters us.

- |                                    |                   |
|------------------------------------|-------------------|
| 1. Professionalism & Communication | 5. Creativity     |
| 2. Teamwork                        | 6. Sustainability |
| 3. Performance                     | 7. Learning       |
| 4. Credibility                     | 8. Happiness      |
|                                    | 9. Growth         |



Our designers deliver layouts that are **functional, efficient, progressive, and sustainable** from concept to completion.

This is achieved through a carefully considered and collaborative design process that addresses the needs and desires of the lives of each occupant.

RD2 implements these values into every project. The goal is to create a lasting and positive experience for everyone that encounters us.



RD2  
DESIGN



# Project Life Cycle



RDZ  
DESIGN



### 1) Design Stage

In the design stage, we work with you to create your concept. This can be anything from a rough idea to a fully conceptualized vision and drawings. Your feedback will help develop the concept.



### 2) Pre-Construction Stage

Once the design is finalized, it's time for the pre-construction stage. During this stage, we'll start with required submissions for approval, begin preparing your space for future layout.

This may include demolishing, partitions, cables installation, all the necessary electrical and plumbing components and any other fixtures that will be included in the final design.



### 3) Construction Stage

In the construction stage, our company focuses on building according to each and every specification.



### 4) Post - Construction Stage

Once the construction stage is complete, it's time to move on to the post- construction stage. The decorations, FFE and final details are verified.



*By placing the focus on the groundwork, the floodgates for ingenuity & innovation are opened, possibilities become infinite.*



RD2  
DESIGN



At RD2, we foster human connection and communication.

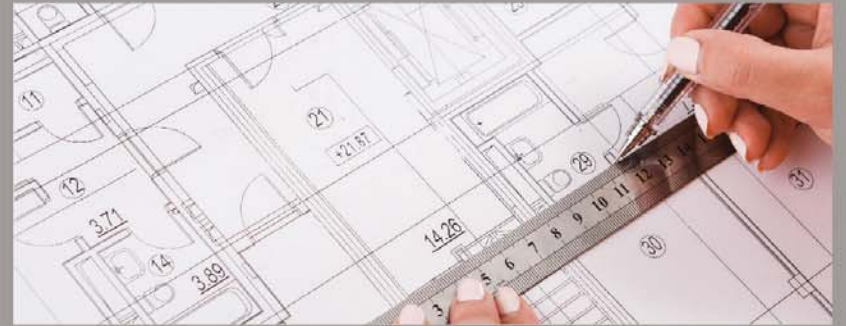





Life is lived in the center of wonder and color.



The best things are seen and known by a mind that is open to thinking outside of the box.



# More Of Our Crafts

Exhibit Stands



F&B Outlets



Events



Offices



# More Of Our Crafts

Branding Design



Hotels



Retail Outlet



Outdoor Areas

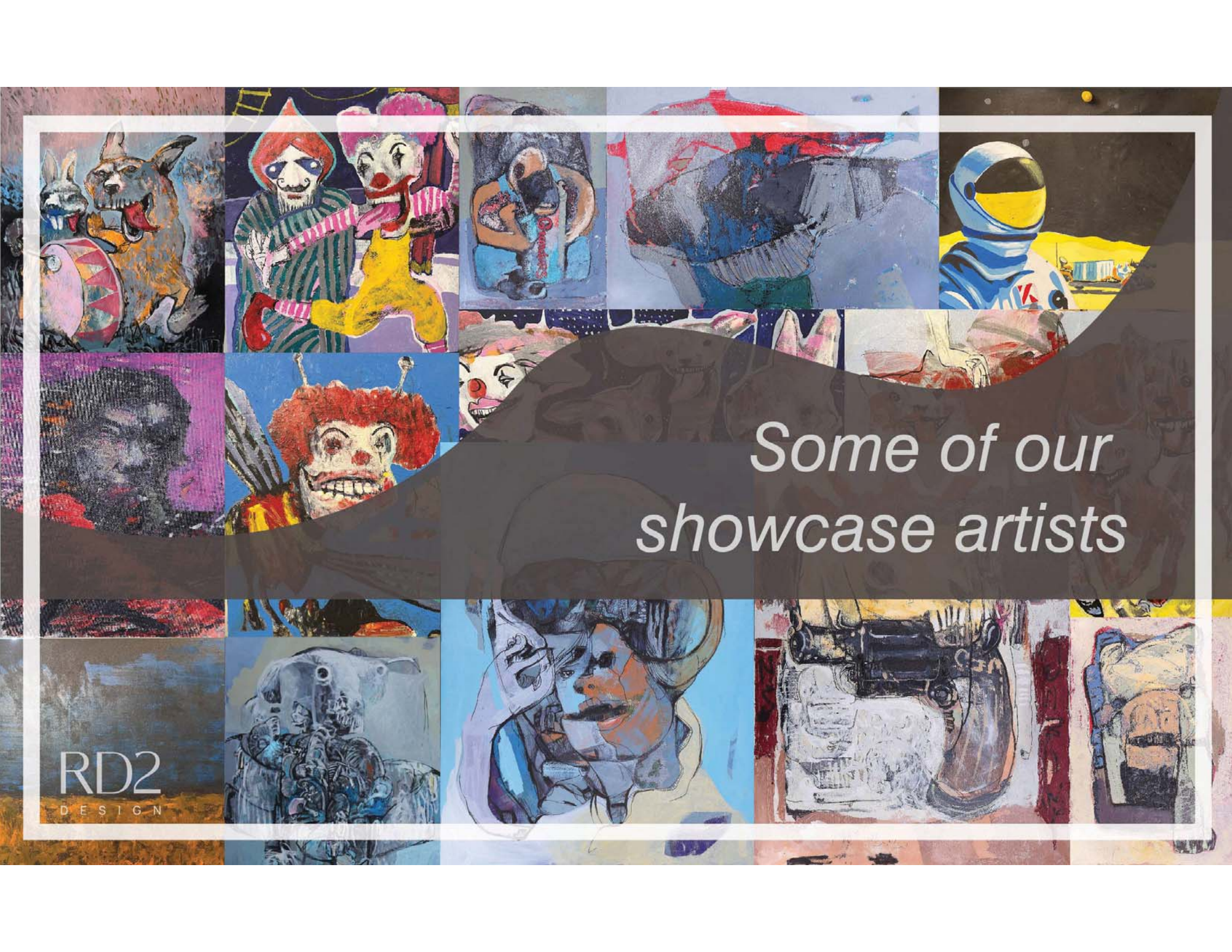

A collage of various artworks including clowns, a rabbit, an astronaut, and abstract figures. The collage is composed of numerous small, overlapping images. In the top left, there's a drawing of a rabbit-like creature with a drum. Next to it is a clown with a red nose and a striped shirt. To the right is an astronaut in a blue and yellow suit. Below these are more abstract and colorful drawings, including a clown with a red afro, a person's face, and a car. The text "Some of our showcase artists" is overlaid on a dark, semi-transparent shape in the center of the collage.

*Some of our  
showcase artists*

RD2  
DESIGN



## **Marlen Sami - The Artist**

Born in Kazakhstan  
(Karaganda)

From his early childhood was always attracted to Art. Along his artist career Marlen worked with multiple sculptures, painters & artists in Kazakhstan, Russia and Czech Republic. Main focus – Abstraction, Impressionism, Cubism, Avantgarde, Action Art, underground, hyperrealism, Biedermeier.



## Aziya - The Artist

Born in Kazakhstan  
(Almaty)

Aziya is an artist who originates from Kazakhstan and currently resides in Czech Republic. Visual arts are at the core of her DNA. Aziya was born in a family of artists & cinematographers. She grew up somewhere between the art studios and the theatrical backstage.

Both influenced & shaped her. Throughout her life, Aziya has experimented with various forms of creativity, from music to fashion design, but painting has always been her primary interest. She holds masters of media & communications from La Salle University. She draws inspiration from media.

In the Illusions series, Aziya presents a surrealistic composition constructed with the imagery conveyed by everyday media content. The goal is to highlight the artificiality of the ideal image & society's trend to pursue happiness by means of flat picture and letterism. The author aims to challenge Semantic conventions and hopes to extend the possibilities of communication.



# Conclusion

From the ground teeming below to the walls that tower into the sky, the team at RD2 Architecture and Interior Design is here to help you create a ***space that will be loved for years to come.***



## Connect with us



+971 52 2218100



rd2@rd2design.com



+971 4 5544102



<https://rd2design.com>



The One Tower, PH2 Sheikh Zayed Road  
Dubai, UAE. PO Box 20609

## Follow us!



@rd2.design